



Metal cabinet with sliding doors h796_20

Office steel cabinet (180x45x200 cm) with sliding doors and 8 adjustable shelves. High-resistance structure for professional archiving.

The **metal storage cabinet** is designed to optimize the organization of documents and materials within offices, professional studios, and administrative secretariats. The structure, made of **first-choice sheet steel**, guarantees high mechanical resistance and long-lasting durability, while the **rounded edges** design ensures maximum safety against accidents in work environments. Thanks to the **sliding doors** closing system, the piece of furniture represents the ideal solution for contexts where maneuvering space is limited, avoiding the bulk of hinged doors.

Technical features

- **Dimensions:** W.180 x D.45 x H.200 cm
- **Material:** first-choice sheet steel
- **Finish:** non-toxic epoxy powder coating
- **Opening system:** 2 sliding doors
- **Internal configuration:** divided into 2 vertical compartments
- **Shelves:** 4 movable shelves for each compartment (total 8 shelves)
- **Adjustment:** adjustable shelves with a 4 cm pitch
- **Color:** RAL 9006 grey

Optional: on request and upon quotation, it is possible to order the piece of furniture in alternative colors.

Image purely indicative

INFORMATION

- **typology** ante scorrevoli
- **Width in millimeters** 1800.000000
- **Depth in millimeters** 450.000000
- **Height in millimeters** 2000.000000

Metal cabinet with sliding doors h796_20

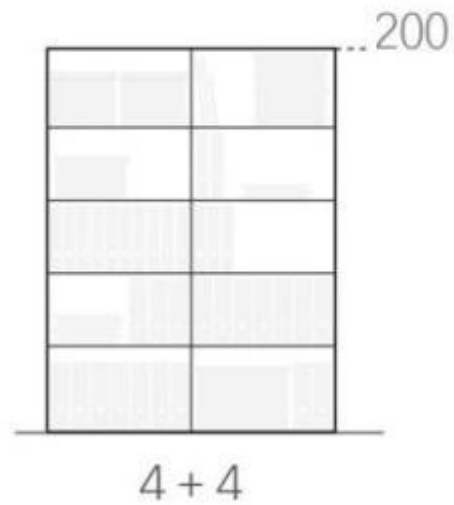

Metal cabinet with sliding doors h796_20

Typology: ante scorrevoli

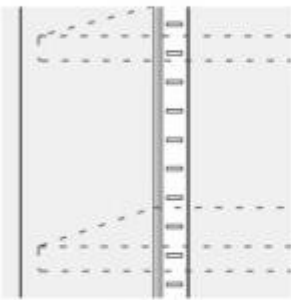

Passo dei ripiani: 4 cm

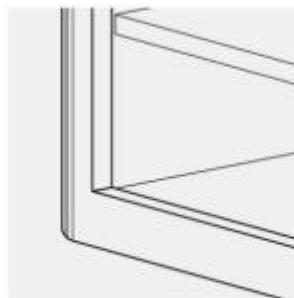

Spigoli arrotondati