



## Filing cabinet with sliding doors h796\_19

Steel office cabinet (150x45x200 cm) with 2 sliding doors, 8 adjustable shelves and rounded edges for professional archiving. This **office cabinet** is designed to ensure a rational and secure organization of documents and consumables in professional contexts such as architectural studios, administrative offices, and school secretariats. The supporting structure, made of **high-quality steel sheet** with high resistance, is treated with non-toxic epoxy powder coatings for long-lasting durability. The **2 sliding doors** closing system allows immediate access to the content while reducing frontal space requirements to zero during opening, a fundamental feature for installation in corridors or offices with limited space. Operator safety is guaranteed by a design with **rounded edges** to prevent trauma.

## Technical features

- Total dimensions: W.150 x D.45 x h.200 cm
- Material: steel sheet painted with non-toxic epoxy powders
- Opening system: 2 sliding doors on tracks
- Internal subdivision: 2 independent vertical compartments
- Shelves included: 4 shelves per compartment (total 8 shelves)
- Adjustment: shelves movable with a 4 cm pitch
- Safety: rounded perimeter edges
- Color: Grey RAL 9006

### Options available on request:

- Chromatic customization with special colors upon dedicated quote.

*Image purely indicative*

## INFORMATION

- **typology** ante scorrevoli
- **Width in millimeters** 1500.000000
- **Depth in millimeters** 450.000000
- **Height in millimeters** 2000.000000

## Filing cabinet with sliding doors h796\_19

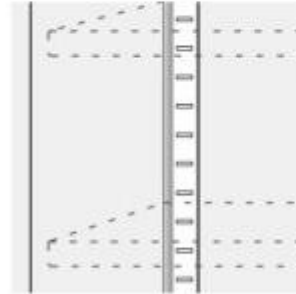

Passo dei ripiani: 4 cm

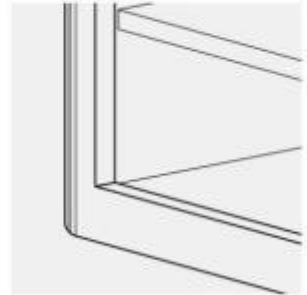

Spigoli arrotondati

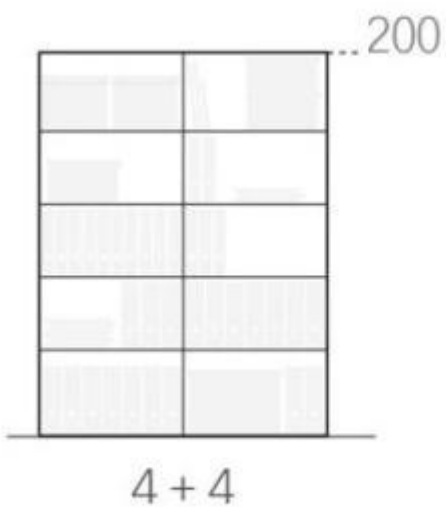

### Filing cabinet with sliding doors h796\_19

Typology: ante scorrevoli